



LED - Waterproof Light

USER MANUAL

• GENERAL

Read the user manual and keep it.

This user manual belongs to this LED damp room light. It contains important information regarding safety and use. To improve clarity, the LED damp room light will hereafter be referred to as the "light."

Read this user manual carefully, especially the safety instructions, before connecting the light.

Keep this user manual for future use. If you pass the light on to third parties, make sure to provide this user manual as well. This user manual can be requested as a PDF file from our customer service.

Explanation of Symbols

The following symbols and signal words are used in this user manual and/or on the packaging of the light.



WARNING!

This signal word indicates a medium-level hazard which, if not avoided, could result in death or serious injury.



CAUTION!

This signal word warns of possible material damage.



Products marked with this symbol comply with protection class II.



Products marked with this symbol are not dimmable.

• INTENDED USE

This light is exclusively suitable for use in enclosed rooms, damp rooms, and covered outdoor areas. The light can be mounted on all normally flammable surfaces. The light is intended for private use only and is not suitable for commercial use.

Use the light only as described in this user manual. Any other use is considered improper and may result in material damage.

• SCOPE OF DELIVERY

Immediately after unpacking, always check the contents for completeness and the device's condition.

- 1 LED damp room light
- 2 mounting brackets
- 4 screws
- 4 wall plugs (anchors)
- 1 user manual

• SAFETY INSTRUCTIONS

Any damage caused by failure to observe this user manual will void the warranty! No liability will be accepted for consequential damage or material and/or personal injury caused by improper handling or non-compliance with the instructions!

For safe use, the user must have read and understood this user manual before using the device for the first time.

The light must only be installed by authorized professionals in accordance with the applicable electrical installation regulations.

Always observe the technical specifications on the packaging and in this user manual.

! CAUTION! RISK ACCIDENTS FOR TODDLERS AND CHILDREN!

Never leave children unattended with the packaging material, as there is a risk of suffocation, among other dangers!

Always keep children away from the product, as this device is not a toy and contains small parts that may be swallowed!

Children or individuals who lack the knowledge or experience to use the device, or who have physical, sensory, or mental impairments, should not use the device without supervision or guidance from a responsible person in charge of their safety.

! AVOID THE RISK OF DEATH FROM ELECTRIC SHOCK!

Before use, ensure that the existing mains voltage matches the required operating voltage of the device (220-240 V ~ 50 Hz).

A damaged device poses a life-threatening risk of electric shock. Do not use the device if you notice any damage. In case of malfunction, immediately turn off the power supply.

! CAUTION! RISK OF INJURY AND/OR ELECTRIC SHOCK!

In case of damage, repairs, or other issues with the light, contact a qualified electrician. Never open any of the electrical components or insert objects into them. Such actions pose a life-threatening risk of electric shock. Do not attempt to repair the device or replace the light source yourself. The light source is non-replaceable; once the light source reaches the end of its lifespan, the entire light must be replaced. The device, including the light source, contains no parts that can be maintained by the consumer.

Do not look directly into the light's beam or its reflection. Never point the beam of the light directly at people. This could lead to glare, causing accidents. If the direct or reflected beam of the light hits your eye, close your eyes deliberately and immediately move your head out of the beam. Never touch the light when it is turned on or becomes hot.

• MAINTENANCE & CLEANING

! CAUTION! RISK OF DAMAGE TO THE DEVICE!

Note:

The device is maintenance-free. The LEDs cannot be replaced. Before cleaning, disconnect the light from the power circuit by turning off the fuse. Then wipe the device with a dry or slightly damp cloth. Do not use abrasive or sharp objects, nor aggressive cleaning agents. Do not use solvents. Regularly check the light for any damage.

The cleaning process is limited to the surface only; no moisture should reach any connection areas or parts carrying mains voltage. Never immerse the light in water or other liquids.

• STORAGE

Always store the light in a dry place, protected from direct sunlight. Keep the light out of reach of children and securely closed.

• DISPOSAL

! DISPOSING OF THE DEVICE:

Devices marked with the symbol shown here must not be disposed of with household waste.

You are required to dispose of such electrical and electronic waste separately. Please contact your local municipality to learn about the proper disposal methods. This ensures that the devices are recycled appropriately and helps avoid negative impacts on the environment.

Disposing of packaging:

Dispose of the packaging in a sorted manner. The packaging consists of cardboard and appropriately marked plastics, which can be recycled.

• INITIAL OPERATION

Check the light and delivery contents

When opening the packaging, be careful not to damage the light with a sharp knife or other pointed objects. Handle the opening process very carefully!

- 1.Remove the light from the packaging.
- 2.Check if the delivery is complete (see "Scope of delivery").
- 3.Check if the light or any parts are damaged. If so, do not use the light. Contact the manufacturer via the service address (see warranty card).
- 4.Connect the light to a properly installed light switch. Follow the installation instructions!
- 5.Before drilling, check the intended installation location for any hidden wiring or supply lines.
- 6.Test the functionality of the light by activating the light switch.
- 7.Never drill into the lamp body!

• ASSEMBLY

REQUIRED MOUNTING MATERIALS:



REQUIRED TOOLS:

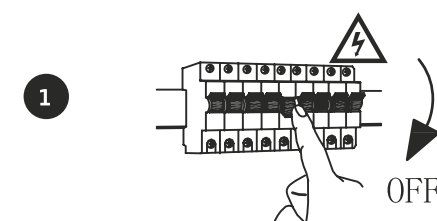
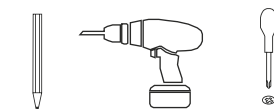

Before installation, turn off the main power source by switching off the circuit breaker or removing the fuse to avoid electric shock. Ensure that the power cannot be turned on again.

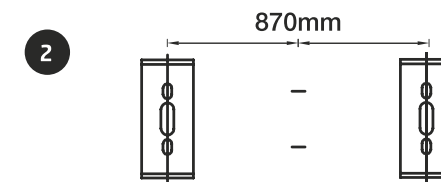

Drill two holes on each side, 6mm in diameter. The distance between the holes is 870mm.

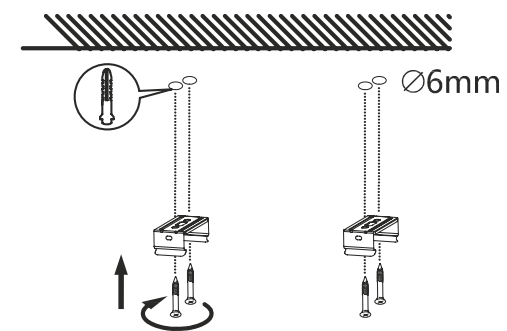

Insert the wall plugs correctly into the drilled holes and attach the brackets to the ceiling using the included screws. Make sure all screws are properly tightened.

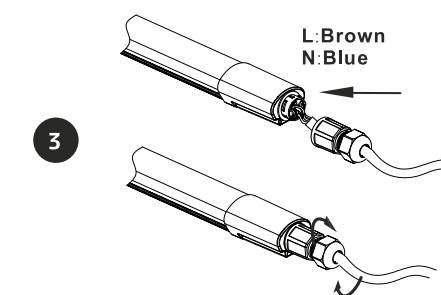

Remove the screw cap.

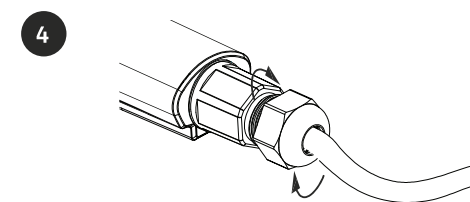

Screw the cover back onto the light and secure it with the screw.

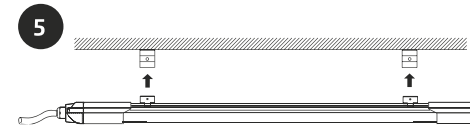

Properly insert the moisture-proof light into the brackets. After installation, check the secure hold of the connection.

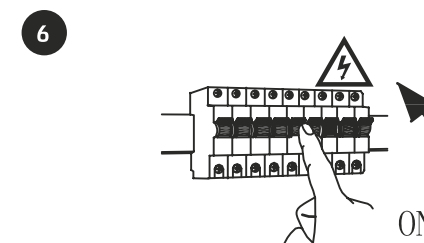

After the installation, turn the main power source back on.

IMPORTER: Prima Group 2004 LTD,
Bulgaria, 1784 Sofia, Mladost 1,
bl. 144, Ground Floor;
Phone: +359 2 988 45 72;